

Ball Check Valves

Series 1500 3600 PSI @ 100°F (248.3 BAR @ 38°C)

These Series 1500 Valves are designed and rated to Flowserve Edward Valves standards. See 3.2 Pressure Ratings in the Technical Information section for additional information.

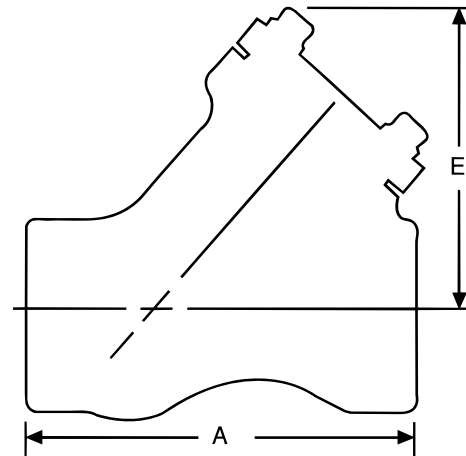
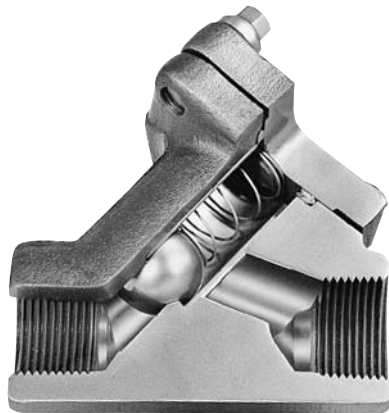

1032

Standard Features

- Bodies and covers are of forged steel (A105 or F11).
- Bolted cover.
- Y-Pattern.
- Integral Stellite seat.
- Asbestos-free spiral wound bonnet gasket.
- Stainless steel spring.
- Stainless steel ball.

Series 1500

FIG. NO.	TYPE	ENDS	NPS (DN)
1032	Y-Pattern	Threaded	¼ (8) thru 2 (50)
1032Y	Y-Pattern	Socket Welding	

Dimensions - Globe

Black numerals are in inches and pounds
Colored numerals are in millimeters and kilograms

Figure No. 1032/1032Y	NPS	¼	3/8	½	¾	1	1¼	1½	2
	DN	8	10	15	20	25	32	40	50
A - End to End		3	3	3	3.6	4.3	5.8	5.8	6.5
		76	76	76	91	109	147	147	165
E - Center to Top		2.8	2.8	2.8	3.3	3.8	4.6	4.6	5.1
		71	71	71	84	97	117	117	130
Weight		2.5	2.5	2.5	3.5	5.5	11	11	15
		1.1	1.1	1.1	1.6	2.5	5	5	6.8